

1

2

3

4

NOTES

BUILDING	SQM net	SQM gross	SQFT gross	Retail & Restaurant SQFT net
A ARRIVAL CANOPY	439.0	439.0	4725.4	
B RETAIL	385.1	405.3	4362.6	4145.2
1-B RETAIL UNIT - DUTY FREE	62.6			
2-B RETAIL UNIT - DUTY FREE	65.0			
3-B RETAIL UNIT - DUTY FREE	65.0			
4-B RETAIL UNIT - DUTY FREE	65.0			
5-B RETAIL UNIT - DUTY FREE	65.0			
6-B RETAIL UNIT - DUTY FREE	62.6			
C RETAIL	320.2	338.2	3640.4	3446.6
1-C RETAIL UNIT - DUTY FREE	62.6			
2-C RETAIL UNIT - DUTY FREE	65.0			
3-C RETAIL UNIT - DUTY FREE	65.0			
4-C RETAIL UNIT - DUTY FREE	65.0			
5-C RETAIL UNIT - DUTY FREE	62.6			
D RETAIL	211.2	226.5	2438.0	2273.3
1-D RETAIL UNIT	51.8			
2-D RETAIL UNIT	53.8			
3-D RETAIL UNIT	53.8			
4-D RETAIL UNIT	51.8			
E RESTAURANT - 1	669.6	669.6	7207.5	7207.7
INT. AC, KITCHEN & SERVICES (gross)	282.6			
BEACH TRELLISS	71.3			
MAIN COVERED AREA	251.7			
TOWER	64.0			
F DOCK EXCURSION CANOPY	336.8	705.8	7597.2	
ARTISAN'S COVERED AREA	369.0			
F RETAIL UNITS	255.2	270.9	2915.9	2746.9
1-F RETAIL UNIT	62.6			
2-F RETAIL UNIT	65.0			
3-F RETAIL UNIT	65.0			
4-F RETAIL UNIT	62.6			
G TOILETS & LOCKERS	184.9	201.0	2163.5	
G RETAIL UNITS	257.5	276.7	2978.6	2771.9
1-G RETAIL UNIT	31.9			
2-G RETAIL UNIT	31.9			
3-G RETAIL UNIT	31.9			
4-G RETAIL UNIT	31.9			
5-G RETAIL UNIT	32.5			
6-G RETAIL UNIT	32.5			
7-G RETAIL UNIT	32.5			
8-G RETAIL UNIT	32.5			
H BUS EXCURSION CANOPY - PHASE I	333.0	333.0	3584.4	
J RETAIL - LOWER LEVEL	774.9	806.4	8680.0	8340.7
1-J RETAIL UNIT	62.6			
2-J RETAIL UNIT	65.0			
3-J RETAIL UNIT	65.0			
4-J RETAIL UNIT	65.0			
5-J RETAIL UNIT	65.0			
6-J RETAIL UNIT	65.0			
7-J RETAIL UNIT - JEWELRY STORE	65.0			
8-J RETAIL UNIT - JEWELRY STORE	65.0			
9-J RETAIL UNIT - JEWELRY STORE	65.0			
10-J RETAIL UNIT - JEWELRY STORE	65.0			
11-J RETAIL UNIT - JEWELRY STORE	65.0			
12-J RETAIL UNIT - JEWELRY STORE	62.6			
J COMMERCIAL - UPPER LEVEL	740.9	806.4	8680.0	7975.2
13-J OFFICE UNIT	62.6			
14-J OFFICE UNIT	65.0			
15-J OFFICE UNIT	65.0			
16-J OFFICE UNIT	65.0			
17-J OFFICE UNIT	65.0			
18-J OFFICE UNIT	65.0			
19-J OFFICE UNIT	31.0			
20-J OFFICE UNIT	65.0			
21-J OFFICE UNIT	65.0			
22-J OFFICE UNIT	65.0			
23-J OFFICE UNIT	62.6			
24-J OFFICE UNIT	34.0			
J UPPER LEVEL OFFICE TOILETS	34.0	34.0		
K RETAIL	292.6	310.1	3337.9	3149.1
1-K RETAIL UNIT	57.2			
2-K RETAIL UNIT	59.4			
3-K RETAIL UNIT	59.4			
4-K RETAIL UNIT	59.4			
5-K RETAIL UNIT	57.2			
L TOILETS	85.2	93.0	1001.0	
M TRAIN STOP	181.3	181.3	1951.0	
N RESTAURANT - 2	508.4	508.0	5468.1	5472.2
INT. AC, KITCHEN & SERVICES (gross)	266.5			
BEACH TRELLISS AND SEATING	241.9			
O RETAIL	320.2	339.5	3654.3	3446.2
1-O RETAIL UNIT - JEWELRY STORE	62.6			
2-O RETAIL UNIT - JEWELRY STORE	65.0			
3-O RETAIL UNIT - JEWELRY STORE	65.0			
4-O RETAIL UNIT - JEWELRY STORE	65.0			
5-O RETAIL UNIT - JEWELRY STORE	62.6			
P INFORMATION & EXCURSIONS	14.4	19.4	208.8	
Q TAXI TOILETS & SHELTER	15.5	18.9	203.4	
R POLICE POINT	8.4	11.6	124.9	
SERVICE/UTILITY	TBC	TBC	TBC	
94 PARKING SPACES				
12 TAXI STALLS				
12 BUS STALLS				
TOTAL AREAS	6737.3	6960.6	74922.0	50975.1

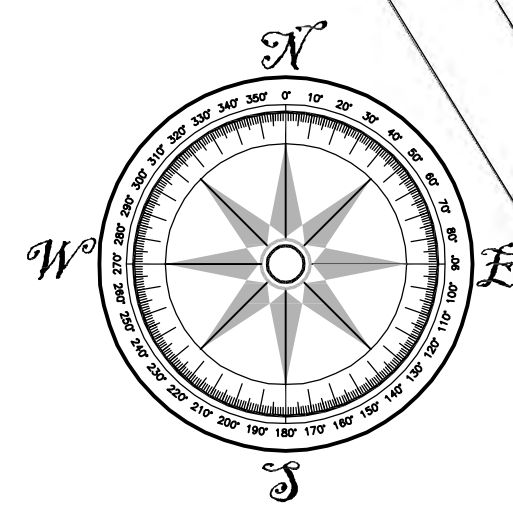

MAR CARIBE

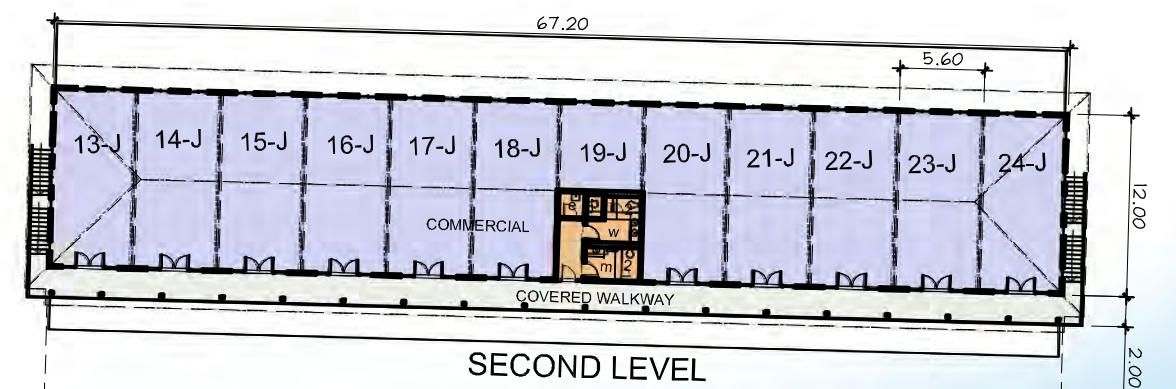

3a Calle 3218
 Colonia La Campaña
 Tegucigalpa
 Honduras
 504-2368126
 504-2217090
 Fax 504-2216889
 www.arquitectnic.com

DATE:	ISSUE:
05-24-11	DD PROGRESS ISSUE
06-13-11	DD PROGRESS ISSUE
06-24-11	DD PROGRESS ISSUE
07-01-11	DD ISSUE
07-08-11	DD ISSUE
08-26-11	DD ISSUE

DATE:	REVISION:
-	-
-	-
-	-
-	-

DESIGN ARCHITECTS
 806 S. DONALDAS RD.
 4TH FLOOR
 CORAL GABLES
 FLORIDA, FL 33134
 WWW.CORALCOMA
 T 305 537 7100



DRAWING:
LEASING FLOOR PLANS AND AREAS

DRAWN BY: NP/RSKL	PROJECT #: 11002
CHECKED BY: DK/NP	SCALE: 1:500
DRAWING #: A-102	

A-1 PROGRAM OF AREAS

A-2 LEASING FLOOR PLANS

SCALE: 1:500